

P E R M I T

CITY OF NAPOLEON
255 W. RIVERVIEW AVE
NAPOLEON, OHIO 43545

DIVISION OF BUILDING & ZONING
PH (419) 592-4010
FAX (419) 599-8393

PERMIT NO: 1777 DATE ISSUED: 07-28-03 ISSUED BY: BND

JOB LOCATION: 11-649 CO RD P EST. COST:

LOT #: SUBDIVISION NAME:

OWNER: SANEHOLTZ, TERI & ED
ADDRESS: O-514 CO RD12
CSZ: NAPOLEON, OH 43545
PHONE:

AGENT: JIM SPEISER & SONS
ADDRESS: 400 E RIVERVIEW AVE
CSZ: NAPOLEON, OH 43545
PHONE: 419-599-1846

USE TYPE - RESIDENTIAL: OTHER:

ZONING INFORMATION

DIST: LOT DIM: AREA: FYRD: SYRD: RYRD:
MAX HT: # PKG SPACES: # LOADING SP: MAX LOT COV:

BOARD OF ZONING APPEALS:

WORK TYPE - NEW: REPLMNT: ADD'N: ALTER: REMODEL:

WORK INFORMATION

SIZE - LGTH: WIDTH: STORIES: LIVING AREA SF:
GARAGE AREA SF: HEIGHT: BLDG VOL DEMO PERMIT:

WORK DESCRIPTION
ELECTRICAL

FEE DESCRIPTION	PAID DATE	FEE AMOUNT DUE
ELECTRICAL PERMIT		0.00

TOTAL FEES DUE 0.00

DATE



APPLICANT SIGNATURE

CITY OF NAPOLEON

ELECTRIC METER BASE RELEASE FORM

THIS DOCUMENT ENTITLES THE HOLDER TO "ONE" ELECTRIC METER BASE
(Please pickup at the City operations garage 1775 Industrial Drive).

PERMIT #: 1777

ISSUED: 07-28-2003

JOB LOCATION: 11-649 CO RD P

WORK DESCRIPTION: ELECTRICAL

OWNER: SANEHOLTZ, TERI & ED

ADDRESS: O-514 CO RD12 NAPOLEON, OH 43545

OWNER PHONE:

CONTRACTOR: JIM SPEISER & SONS

ADDRESS: 400 E RIVERVIEW AVE NAPOLEON, OH 43545

CONTRACTOR PHONE: 419-599-1846

ELECTRIC SERVICE UPGRADE _____ NEW SERVICE INSTALLATION X

11-649 CO RD

INDUSTRIAL _____ COMMERCIAL _____ RESIDENTIAL X 1PHASE ~~3~~ 3PHASE _____

SIZE OF SERVICE 100AMP _____ 150AMP _____ 200AMP X 400AMP _____ OTHER _____

HUB SIZE - 1 1/4" _____ 1 1/2" _____ 2" _____

DESIRED VOLTAGE 120/240 X OTHER _____

UNDERGROUND SERVICE X OVERHEAD SERVICE ~~3~~

=====

DATE COMPLETED: _____ APPROVED BY: _____

OLD METER NUMBER: _____ NEW METER NUMBER: _____

COMMENTS:

CITY OF NAPOLEON GENERAL PERMIT APPLICATION
THIS APPLICATION IS FOR RESIDENTIAL CONSTRUCTION INCLUDING BUILDING, ELECTRICAL,
PLUMBING, MECHANICAL, DEMILITIONS, REMODELING

Date 7-28-03 Job Location 11-649 Co. Rd P

Owner Ed + Teri Saneholtz Phone * 419-592-4146 *

* Owner Address 0-514 Co. Rd 12 * City Napoleon Zip 43545

Contractor Speiser Phone _____

Description of work to be performed run new line

Estimated cost of work to be performed ?

Below Please check the work that you will be doing!!

- | | |
|---|--|
| <input type="checkbox"/> A/C Add On | <input type="checkbox"/> Remodeling |
| <input type="checkbox"/> Boiler Replacement | <input type="checkbox"/> Roofing |
| <input type="checkbox"/> Curbing | <input type="checkbox"/> Sewer Repairs |
| <input type="checkbox"/> Decks | <input type="checkbox"/> Sidewalk |
| <input type="checkbox"/> Driveway | <input type="checkbox"/> Siding |
| <input type="checkbox"/> Electrical Service Upgrade | <input type="checkbox"/> Sign |
| <input type="checkbox"/> Electrical New | <input type="checkbox"/> Storage Shed |
| <input type="checkbox"/> Fence | <input type="checkbox"/> Street Bond |
| <input type="checkbox"/> Foundation | <input type="checkbox"/> Swimming Pool |
| <input type="checkbox"/> Furnace Replacement | <input type="checkbox"/> Temp Electric |
| <input type="checkbox"/> Furnace New | <input type="checkbox"/> Water Tap |
| <input type="checkbox"/> Lawn Meter | <input type="checkbox"/> Windows |
| <input type="checkbox"/> Plumbing | <input type="checkbox"/> Zoning |
| <input type="checkbox"/> Others | |

____ Permit Number

N 11-649 Co Rd P

Co. Rd. P

C.L. # of Road

from the center of Co. Rd. P, 703'-9" south is the last farm tile tile are 50ft apart

House sets back off of Rd P approx. 1,000ft

Set poles on West side of drive, and if possible put underground the last 150-200ft

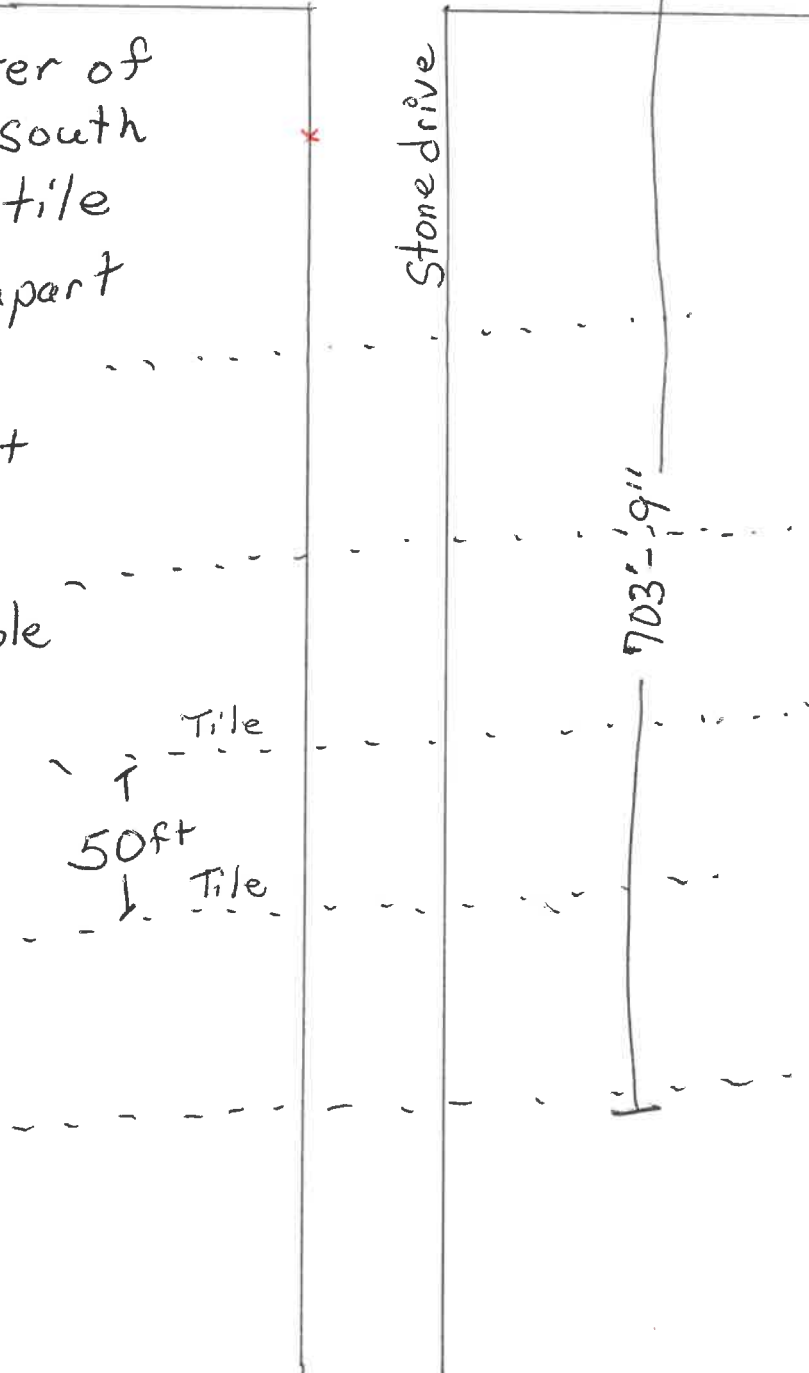

Ed Saneholtz
419-592-4146

